

**60 HARDING AVE.
OAKLYN, NJ**

DETAILED FLOOR PLANS •



ROOMINDERS • REAL ESTATE MARKETING

p 856.429.4233

web - www.roominders.com

f 856.429.8118

e jon@roominders.com

measured by Jon Hitchner 8.7.09

Revised -

* Actual measurements may vary

* Not to be used for construction purposes

* Position of walls and fixtures are approximate

* Only to be used with written permission

APPROXIMATE
SQUARE FEET

4,865

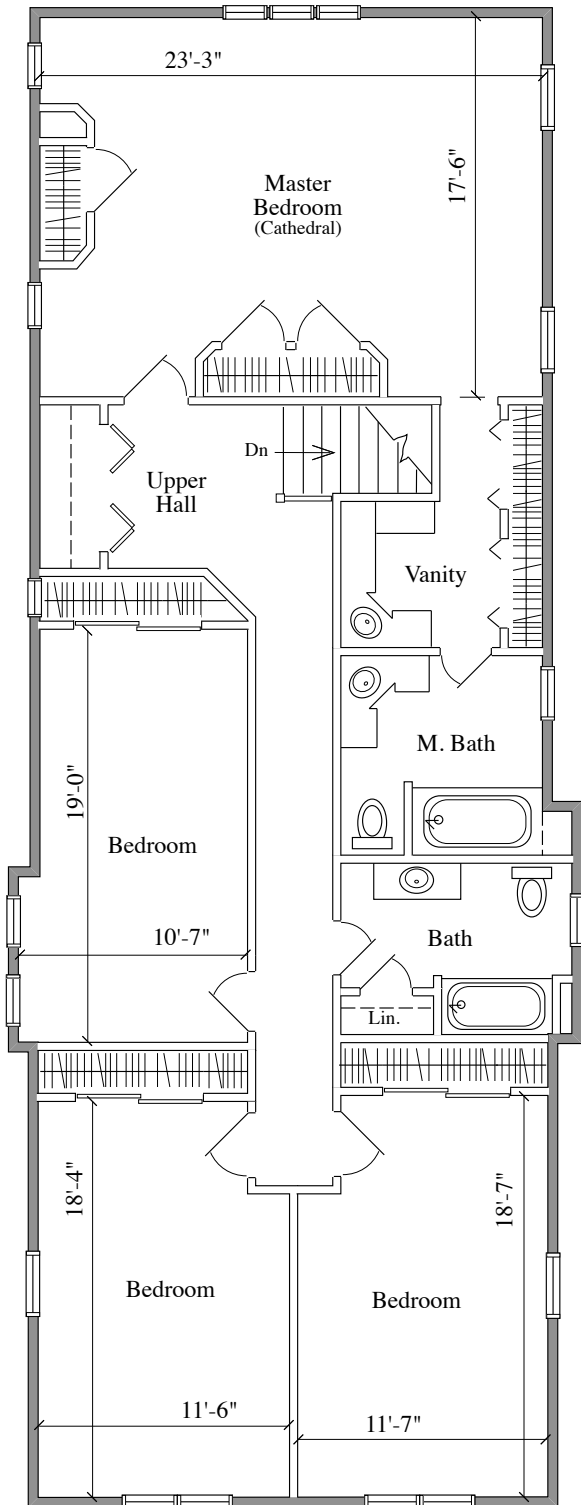

**SECOND FLOOR
1,710 SQ. FT.**

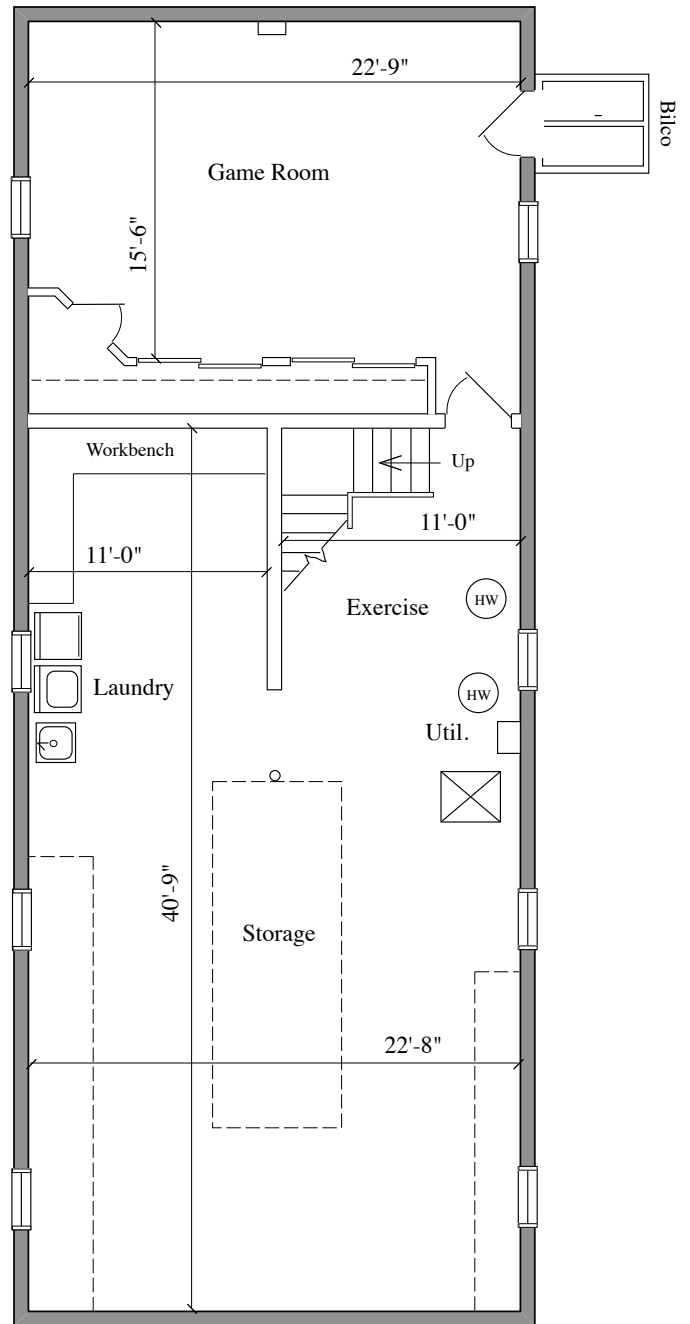

**BASEMENT
1,470 SQ. FT.**